

LARGE EZ BARRIER

EZ TUBE DISPLAYS

PRODUCT CODE: EZBRRLG



On frame On graphic



Barrier Connector Foot (Optional)

PRODUCT DESCRIPTION

The new EZ Barrier brings lightweight portability to advertising barrier display systems! Suitable for indoor use, use the EZ Barrier as crowd control at your next trade show or event. Custom printed dye-sub fabric graphic drapes over entire aluminum frame and zips closed. Choose single-sided graphic with black or white backside or double-sided graphic.

Optional: Join together multiple EZ Barriers with Barrier Connector Foot.

DISPLAY DIMENSION	78" W x 35" H x 19.7" D
-------------------	-------------------------

GRAPHIC DIMENSIONS	81" W x 36" H
--------------------	---------------

GRAPHIC MATERIAL

Stretch Fabric

GRAPHIC FINISHING

Sewn left, right, and top with a zipper at the bottom

DISPLAY CONSTRUCTION

Aluminum Frame

SHIPPING WEIGHTS & DIMENSIONS

Shipping Weight	20 lbs (frame only) 21 lbs (with graphics)
-----------------	---

Shipping Dimensions	28" H x 12.5" W x 6" D
---------------------	------------------------

LARGE QUANTITY FREIGHT

Freight Shipping	40 boxes per 48" L x 40" W x 66" H skids
------------------	--

Freight Weight	800 lbs (frame only) 840 lbs (with graphics)
----------------	---

GRAPHIC TURN AROUND TIME

2 business days after proof approval

AVAILABLE ACCESSORIES

Barrier Connector Foot

AVAILABILITY	CA and PA
--------------	-----------



Straight Barrier Connection (Optional)



Corner Connection (Optional)

LARGE EZ BARRIER

EZ TUBE DISPLAYS

PRODUCT CODE: EZBRLG

PARTS LIST



Qty 2 - Curved Tube



Qty 2 - Vertical Tube



Qty 2 - L Tube



Qty 4 - Horizontal Tube



Qty 2 - Middle Tube



Qty 2 - Wire Lock Pin



Qty 2 - Feet

Dims: 19.7" L x 3" W x .3" H

LARGE EZ BARRIER

EZ TUBE DISPLAYS

PRODUCT CODE: EZBRRLG

SET UP INSTRUCTIONS

Set Up Frame

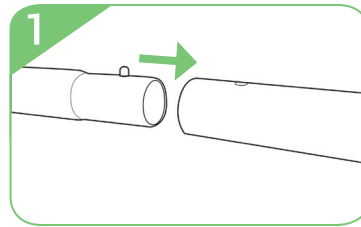
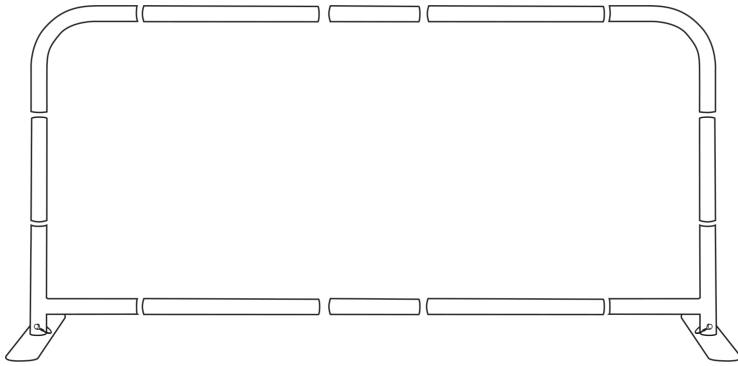

Connect numbered tubes together.

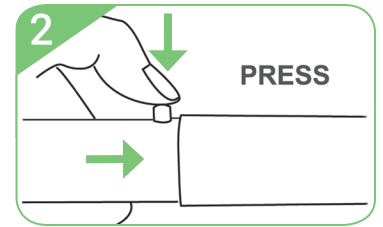

Push down on button and insert tube.

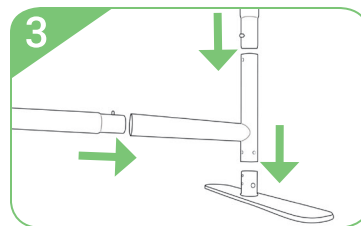

Attach corner tube onto feet. Then connect vertical and horizontal tubes to complete frame.

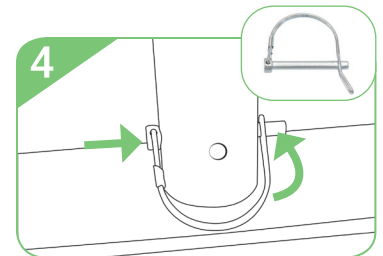

Insert wire lock pin onto the side of feet. Then pull wire loop over end of the pin to secure feet.

Install Graphic

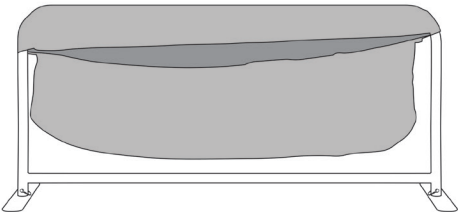

a. Drape graphic over frame.

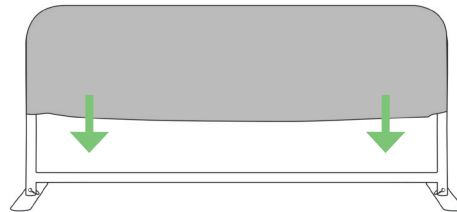

b. Pull down graphic to cover whole frame.



c. Zip underneath the bottom support pole.

Optional Connection



a. Use barrier connector foot to arrange your own combination barrier.



b. Place frames onto barrier connector foot and lock with wire lock pins.



c. Arrange barrier either straight or corner.



LARGE EZ TUBE BARRIER

SET UP INSTRUCTIONS

Set Up Frame

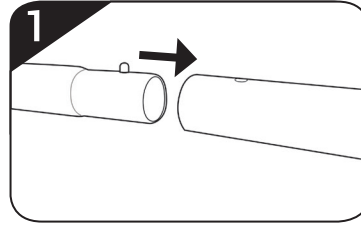

1 Connect numbered tubes together.

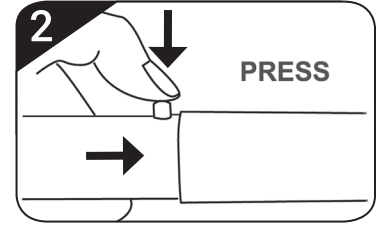

2 Push down on button and insert tube.

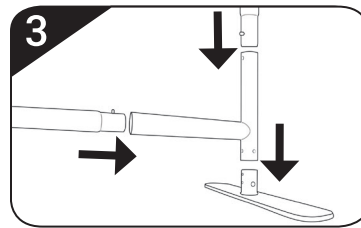

3 Attach corner tube onto feet. Then connect vertical and horizontal tubes to complete frame.

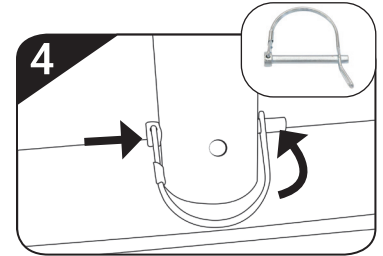

4 Insert wire lock pin onto the side of feet. Then pull wire loop over end of the pin to secure feet.

Install Graphic

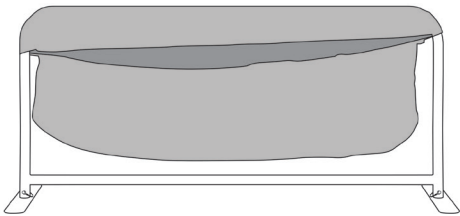

a. Drape graphic over frame.



b. Pull down graphic to cover whole frame.



c. Zip underneath the bottom support pole.

Optional Connection



a. Use barrier connector foot to arrange your own combination barrier.



b. Place frames onto barrier connector foot and lock with wire lock pins.



c. Arrange barrier either straight or corner.

