

Show 'n Rise (CURVED) 12 QUAD_FLOOR

339008 thru 339011

Item #	NAME	Graphic Panels	Viewable Graphic Size (when flat)	Fabric Panels	CASE WRAP
339008	10FT HARDWARE KIT-no lights	NONE	NONE	NONE	no wrap
339009	10FT FABRIC KIT-w/light	NONE	No graphics-FABRIC	(4)Center (2) End	Fabric
339010	10FT MURAL KIT/Fabric Ends-w/light	(4) Center	110.5"w x 89.5"h	(2) End	Fabric
339011	10FT MURAL KIT-w/light	(4)Center (2) End	156.5"w x 89.5"h	NONE	Graphic

Product Parts for HARDWARE (STEPS 1 THRU 5)

1 - Mural Graphic Face Plates (qty: 28)**
 2 - Mag Rails (qty: 7)
 3 - Oval Hard Case
 4 - Hardware Bag
 5 - Frame

****Frame (3) should come with Face Plates already installed.**

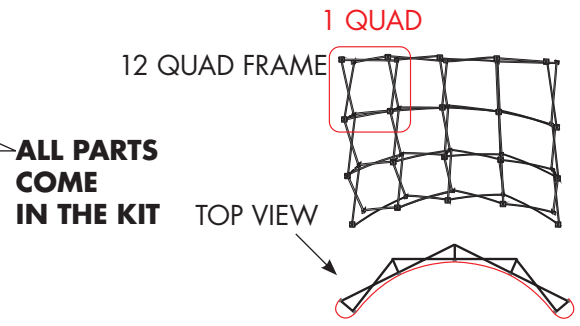

Product Parts for PANEL KITS and LIGHTS

6 - Double LED light kit
 7 - Panels (see chart above for qty and panel style)
 8 - Case to Counter Kit

8a Oval Top
 8b wrap

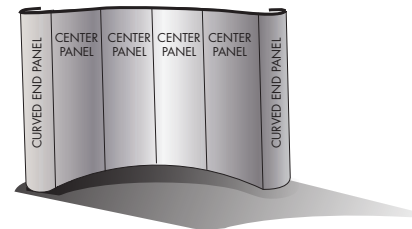

Display Set-Up

Step 1

Remove all parts from your Hard Case (3) and place on a flat, clean surface. Review the Frame (5) and notice where the pivoting light clips are located. This will determine the TOP of the display.

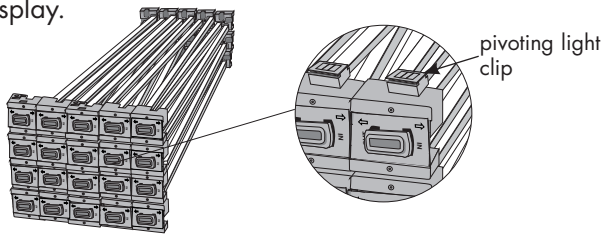

Step 2

Pull the Frame (5) up and out from the corners until it is fully expanded on the floor.

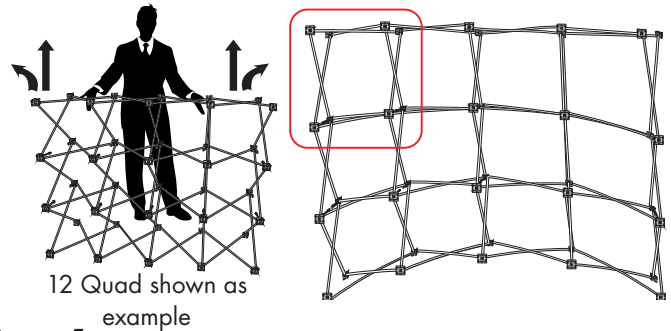

Step 3

Push all locking clips together to secure the Frame (5) in its expanded position.

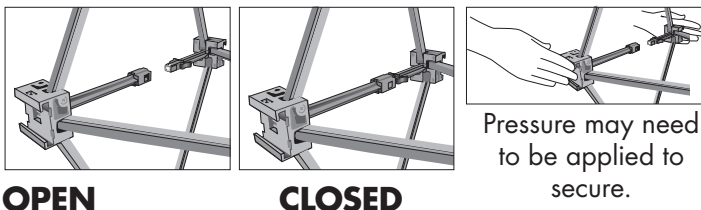

Step 4

With Frame (5) set up and in locked position, you will now be installing all of the Mag Rails (2). Steps 5 thru 9 show how to install the Mag Rails (2) as well as an instructional video:

http://creativedisplaysite.com/Mag_Rail_Install.html

Display Set-Up Continued

Step 5:

With 3-sectioned Mag Rail (2) folded, (**fold so pins are UP and facing away from the frame**) start with **BOTTOM** section and slide back slot onto Mural Graphic Face Plates (1) on Frame.

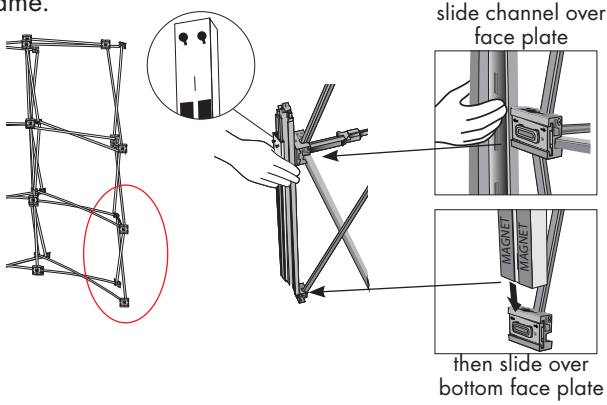

Step 6:

Unfold Mag Rail (2) and fold TOP section onto MIDDLE section. (pins will now be facing the magnets on the middle section)

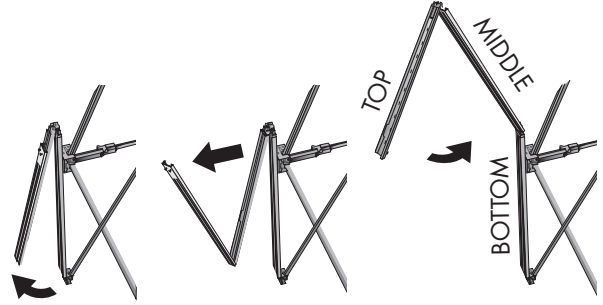

Step 7:

Slide MIDDLE section onto the next upper hub, then interlock to bottom section.

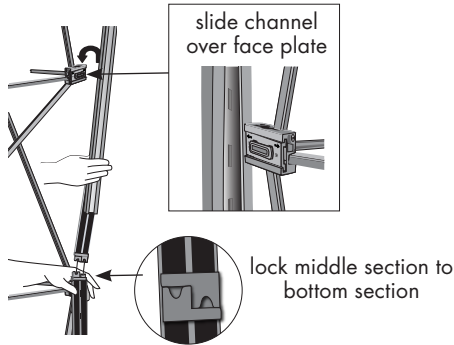

Step 8:

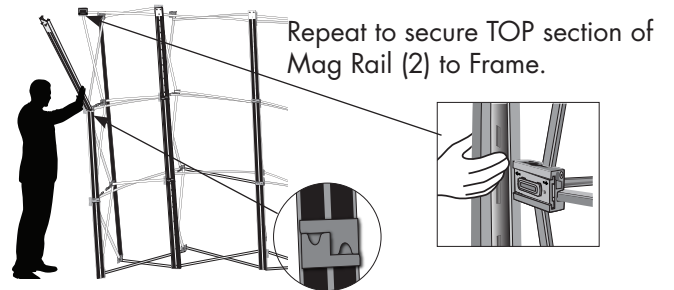

Step 9:

Connect the Mag Rails (2) to the Frame (5) on all front connection points as well as the back vertical ends. Once all Mag Rails (2) are installed give the rails a shake to verify that are all secure.

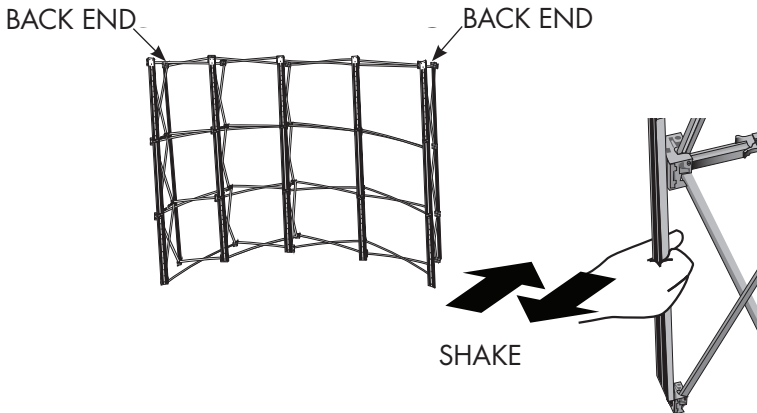

Step 10:

Determine which Mag Rail (2) light (6c) will attach to, and insert clip (6-b) from LED kit (6) into top of Mag Rail (2). Install LED light (6-c) from LED kit (6) onto inserted clip (6-b)

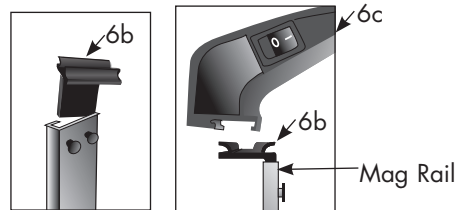

Display Set-Up Continued...

Step 11:

Set all plastic wrapped panels (7) out on floor in order of how they will be installed. All panels are installed by hooking the notch located on the top of the panel (7) to the pins at the top of the mag rail (2).

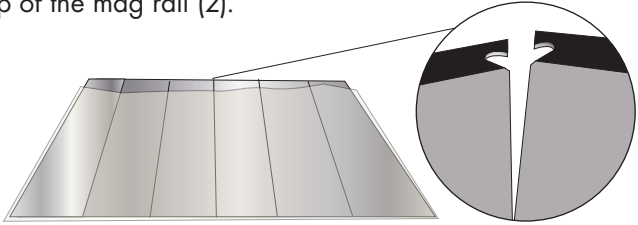

(KEEP the protective sleeves as they will be used for storage.)

Step 12:

Install the Panels (7) to the Frame (5). Start with the end panel. Remove it from protective sleeve, and while holding it in a curved position, hook the notches over the pins at the top of front end and back end Mag Rail. With top notches secure, slide your hands down each side of the curved end panel securing it to the vertical Magnets.

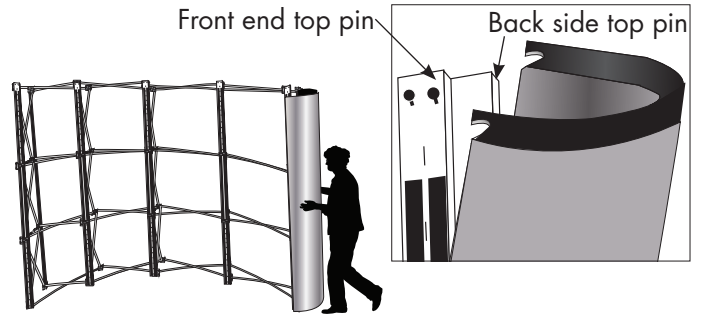

Step 13:

Secure the rest of the panels using the same method as in Step 8.

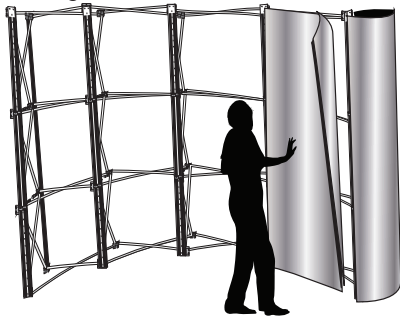

Step 14:

Plug lights (6) into power source. Display is now ready.

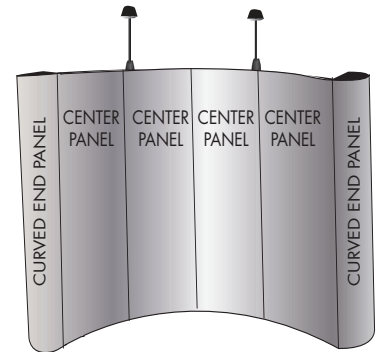

Step 15:

Secure Wrap (8b) to the Oval Case (3). Velcro® connection point will be on the backside of Case (3).

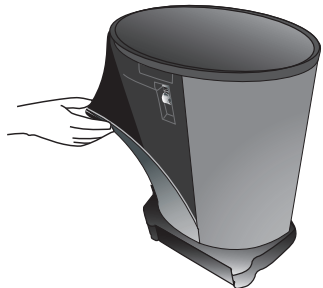

Step 16:

Place the oval Top (8a) part of the Case to Counter Kit (8) in the groove on top of the Oval Case (3)



Disassembly Instructions

Step 1

Remove all Panels (7) and carefully roll them up graphic/fabric side out. Place into clear protective sleeves.

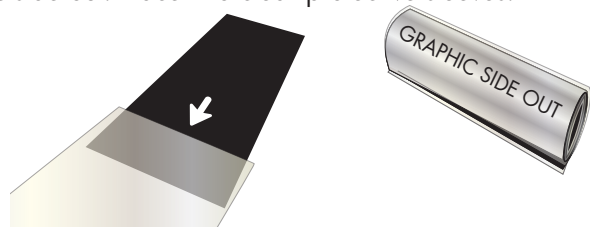

Step 2

Place rolled Panels (7) into Oval Hard Case (3).



Step 3

Unplug and remove lights (6c) and clips (6b) from Frame (5). Place in carrying case.



Step 4

Remove all Mag Rails (2) from Frame (5). Collapse and place in hardware bag (4).

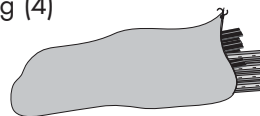

Step 5

Collapse Frame (5). **MAKE SURE ALL LOCKING CLIPS ARE IN OPEN POSITION** before collapsing Frame (5)

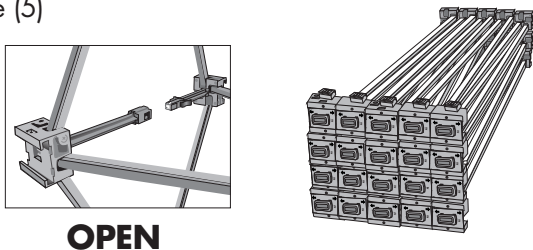

SET-UP NOTE:

Display should have Face Plates (1) already installed in Frame (5). If not, Slide (with force) the Face Plate (1) into the hubs. Typically you will slide RIGHT to LEFT when looking at the face of the Frame (4).

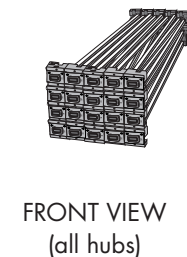
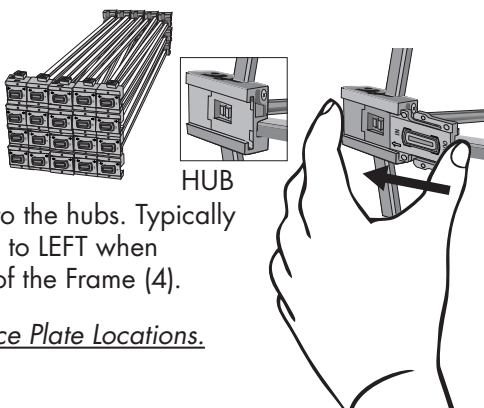

See opposite for Face Plate Locations.

NOTE: FRAME HARDWARE HAS HUBS THAT CAN BE INTERCHANGED TO DISPLAY OTHER PRODUCTS
Conversion kits sold separately-contact client services for more details